

Product Installation Manual

Pull-out Kitchen faucet

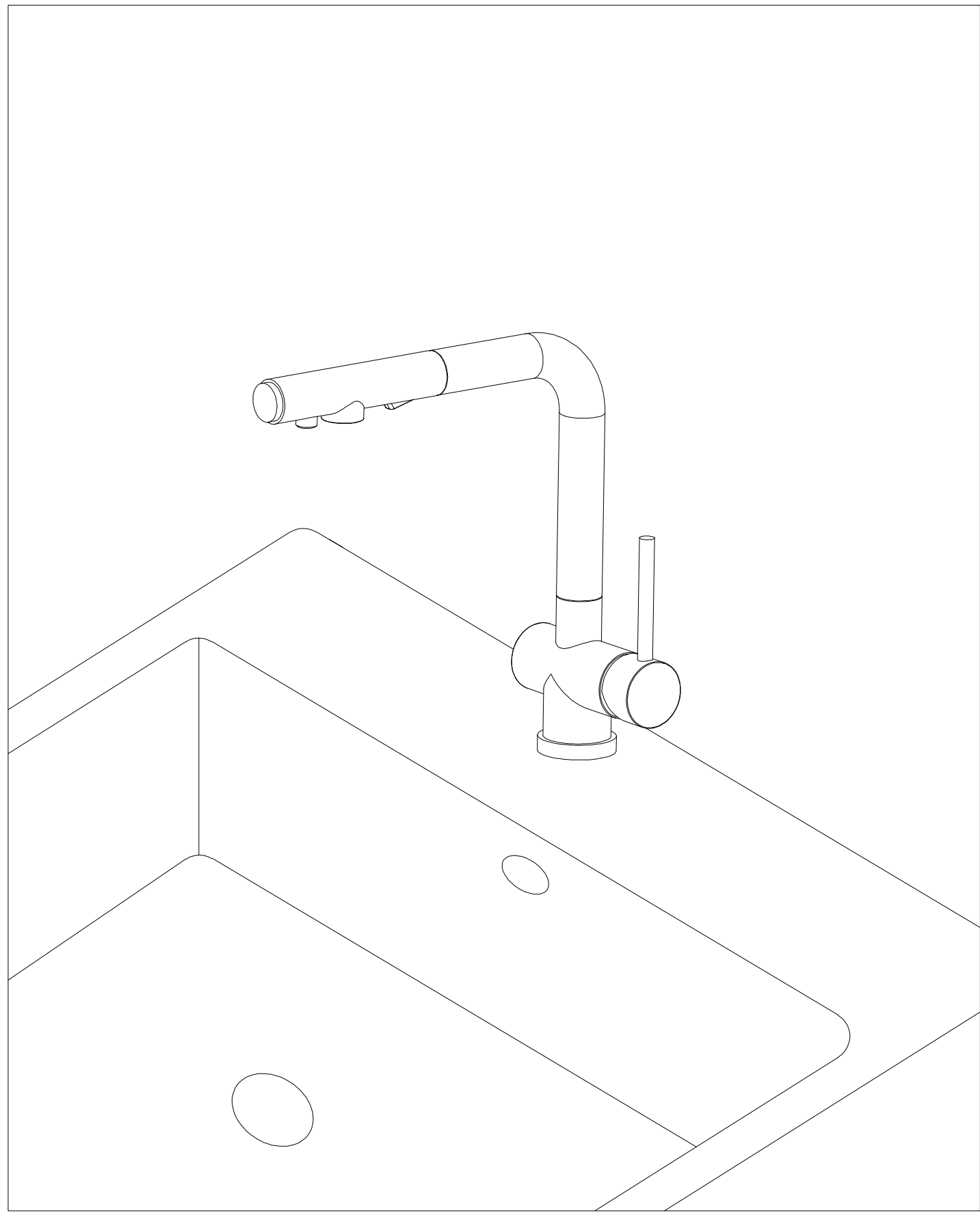

1. Installation Condition

- 1、 Refer the 《Standard Part List》 When you open package, check all parts available.
- 2、 Ensure basin you buy is matching with the mixer's size.
- 3、 Do not dissemble mixer body by yourself.
- 4、 Connect inlet hoses to supply stopper. Left hose to hot water supply, and right hose to cold water supply.
- 5、 Determine inlet hoses to supply stopper. Left hose to hot water supply, and right hose to cold water supply.
- 6、 When finished installation, check all joints and connections for leaks.
- 7、 Water pressure shall be: 0.05Mpa≤ Water pressure ≤ 0.75Mpa.Suitable water temperature: 4℃-80℃
- 8、 The hose can not be over-bended. And make sure the hose will not be out of shape.

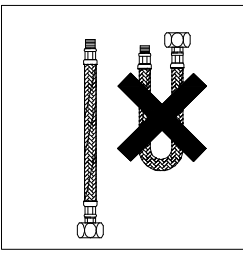
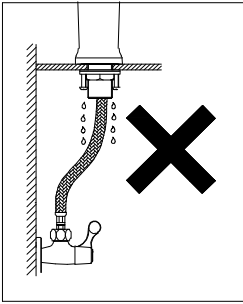
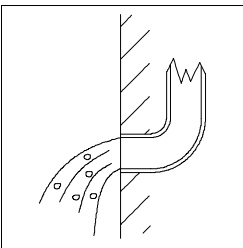

Tools required :

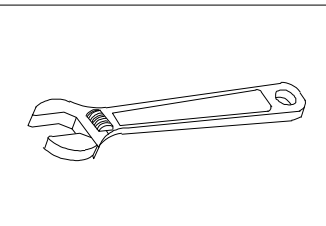

Activity wrench

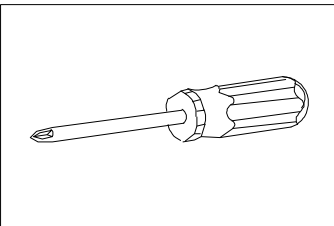

Screwdriver

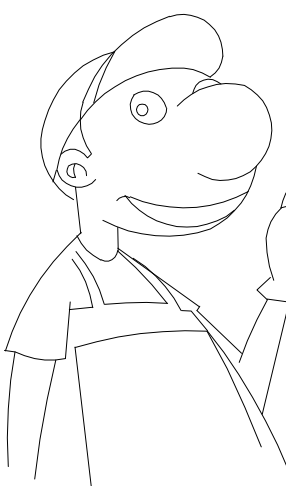

KIND TIPS: 1. Suggest that faucets are fitted in two months after the completion of your house decoration.
2.Suggest don't fit the faucet in the severely corrosive environments; if needed, please often clean the faucet surface order to maintain its service life.

4. Installation Step

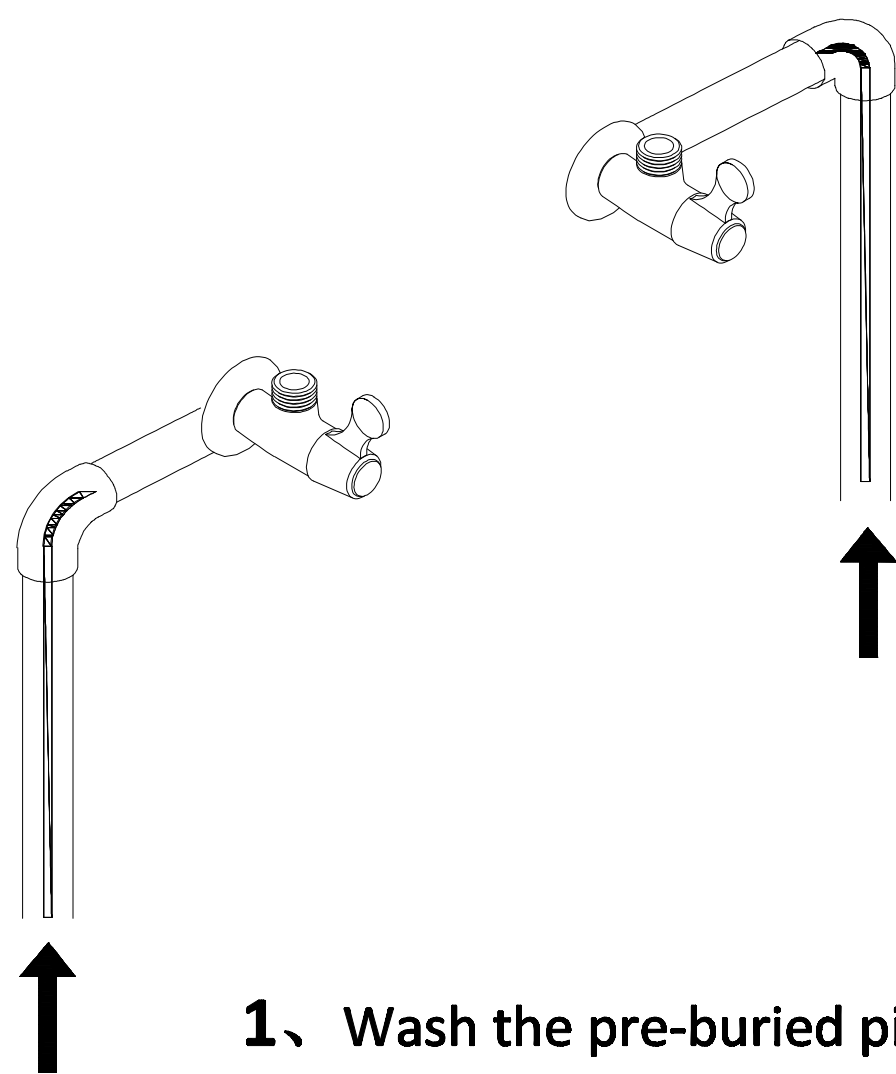

1、 Wash the pre-buried pipe before installing the faucet

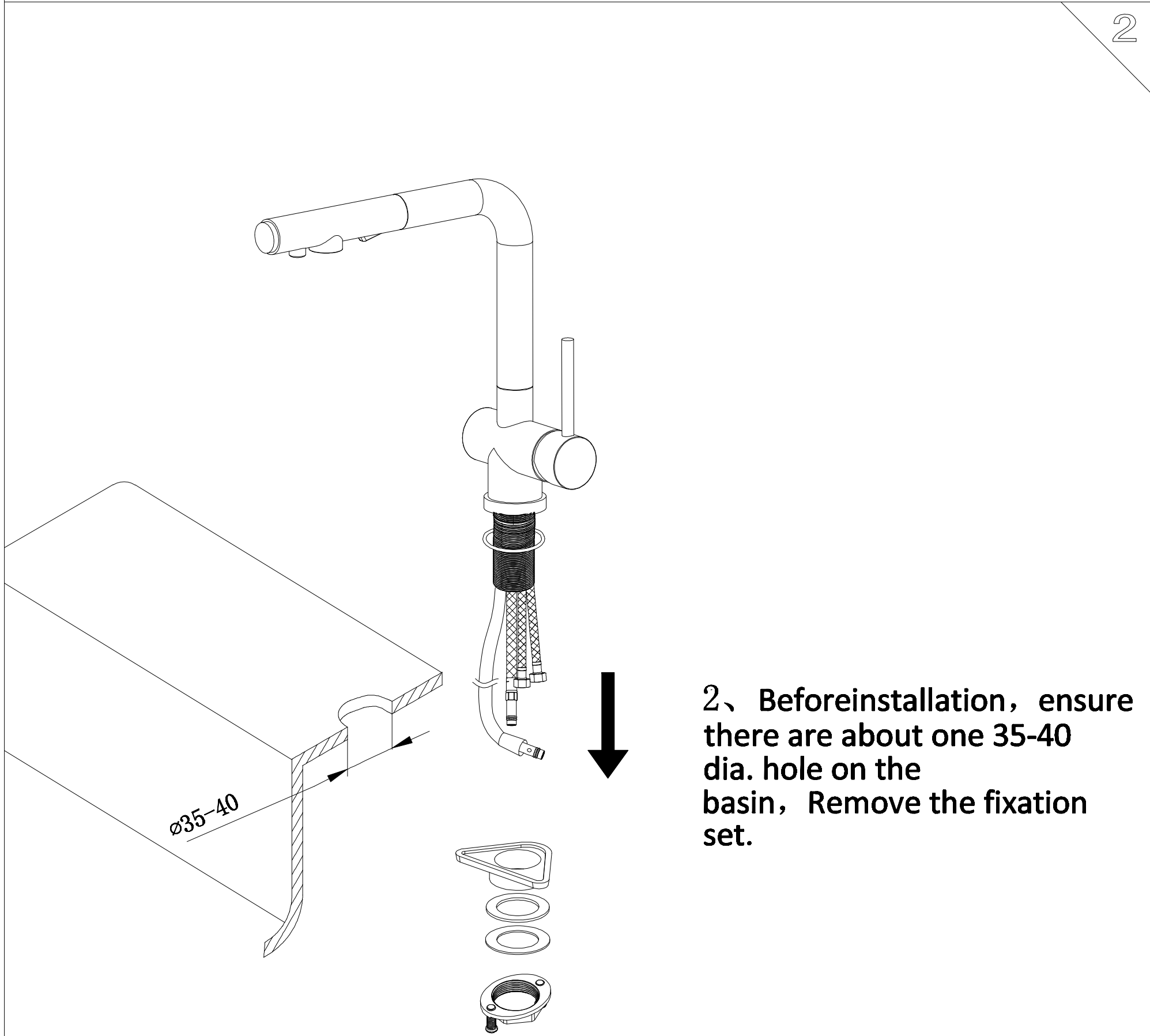

2、 Beforeinstallation, ensure there are about one 35-40 dia. hole on the basin, Remove the fixation set.

2、 Standard Part List

(NO.)	(Part Name)	(Quantity)
1	(Faucet Body)	1
2	(O-Ring)	1
3	(flexible hose)	2
4	(Fixation System)	1
5	(Weight ball)	1
6	(Instruction Manual)	1
7	(adapter)	1

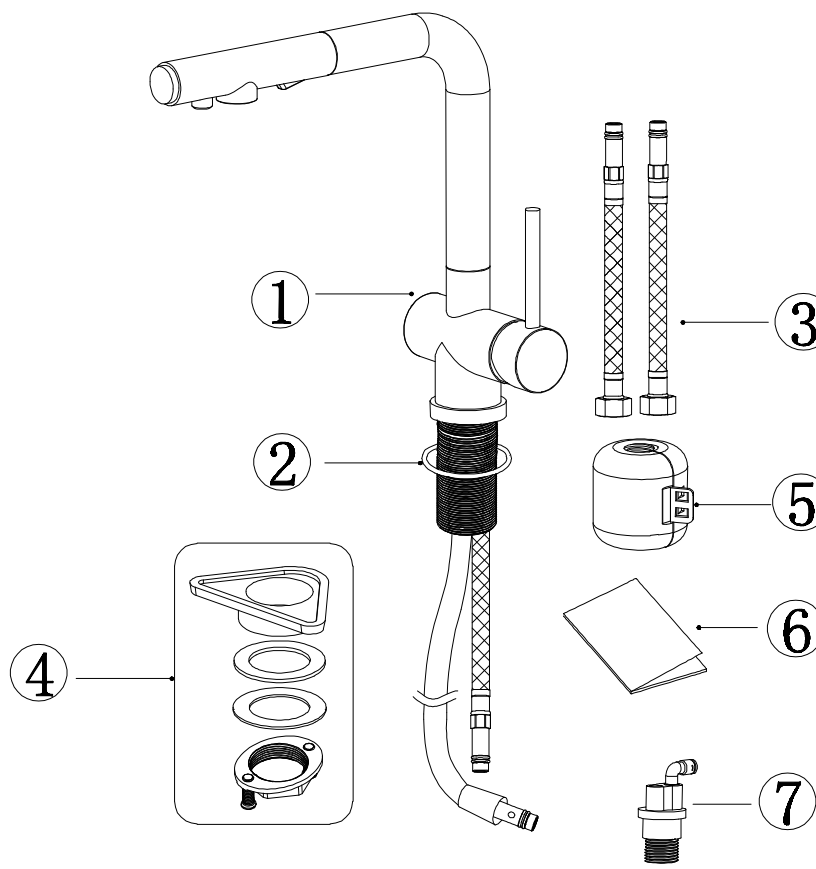

3、 Essential Dimension Diagram

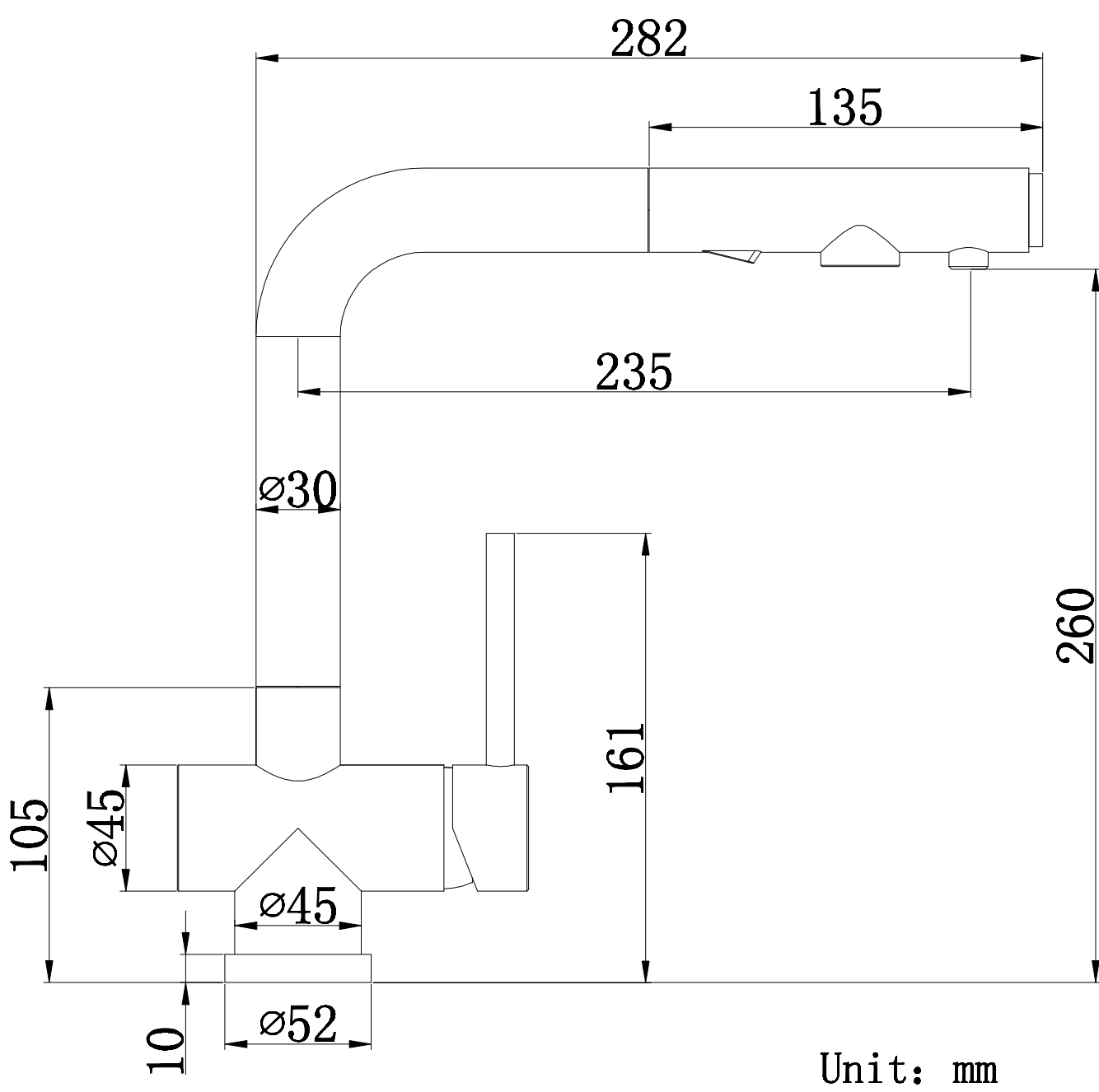

Unit: mm

Icon dimensions are for reference only

Our company all along enhance and improve its product design and the performance policy unceasingly; And retain to its product change authority, Do not inform at the appointed time.

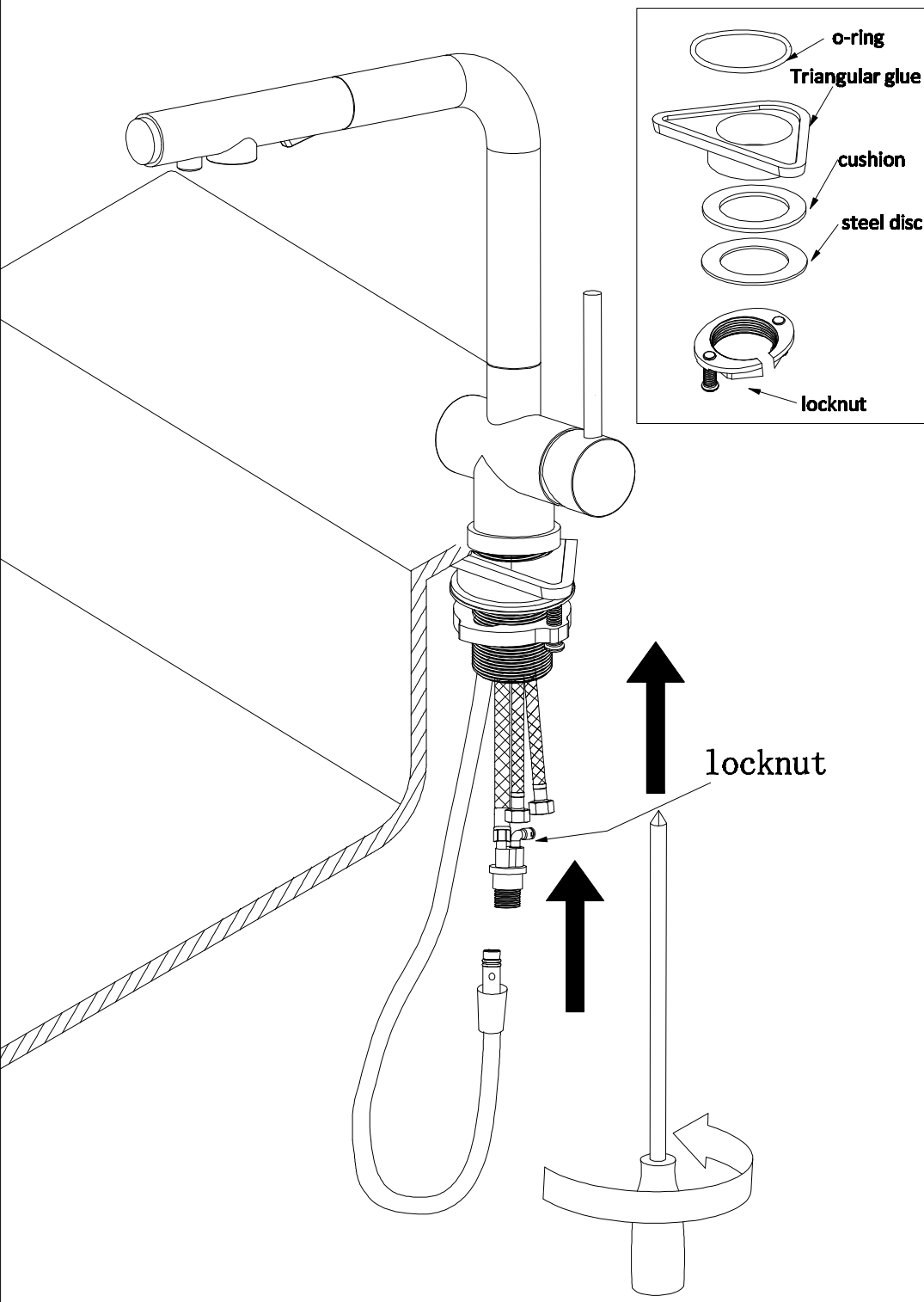

3、 Assemble the faucet into the hole and put the O-ring on the bottom of faucet .According the remove step the fixation set from the basin bottom to faucet installation base.Use wrench screw the locknut, then use cross screwdriver to screw the cross screw on the locknut, strenthen the fastness.Install the adapter on the outlet pipe,

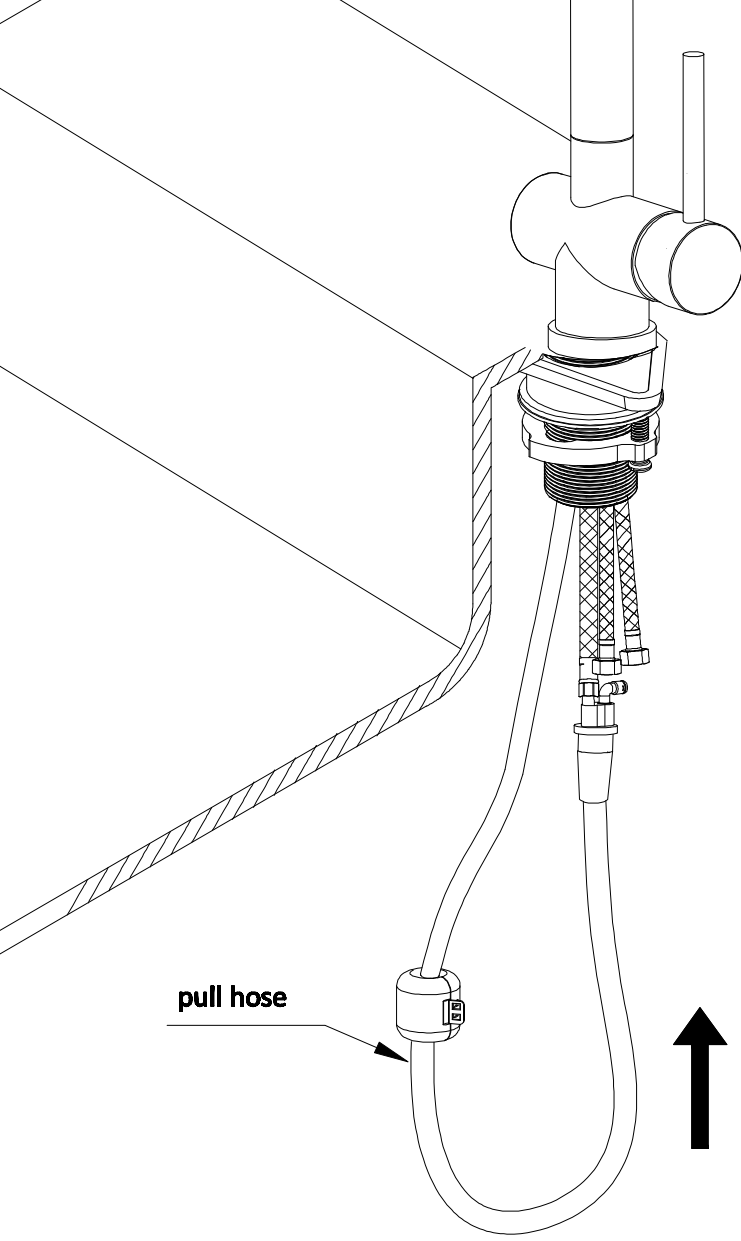

I . Open the counter weight and install the counter weight on the faucet pull hose.
II . Put the pull-out hose in the quick connector, until hearing the voice of "click-click" on the quick connector.
Notice: After installation, please try to pull many times of shower head and make sure whether it is smooth, and it can be returned back, if not, please adjust the position of weight ball, until the shower head can be returned back smoothly.

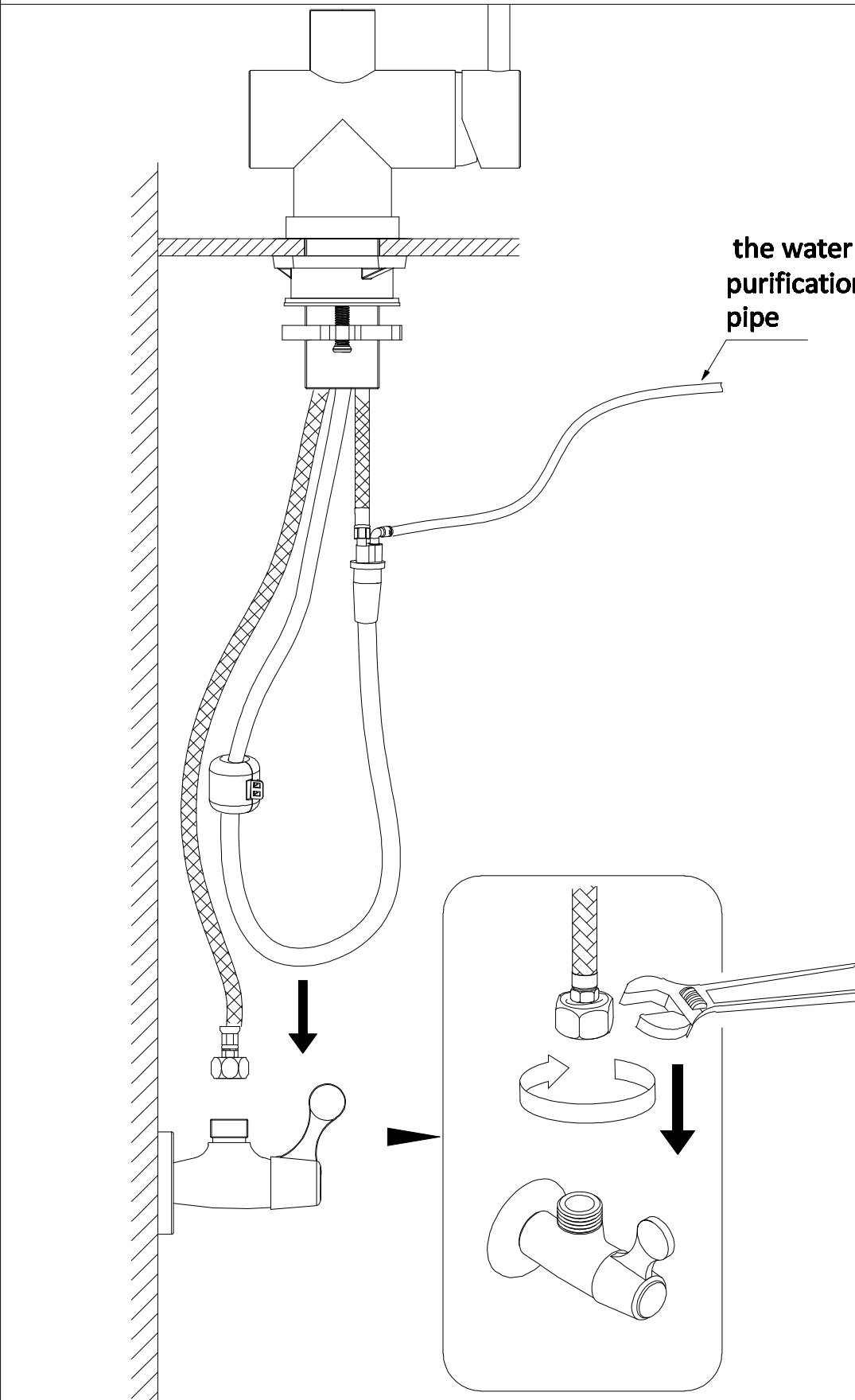
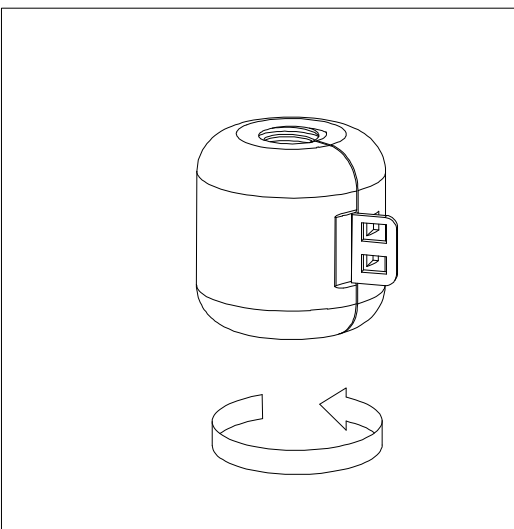

5、 Connect two inlet hoses on the facet to angle valve. Connect red inlet hose to hot water supply, and blue inlet hose to cold water supply.Then connect the water purification pipe

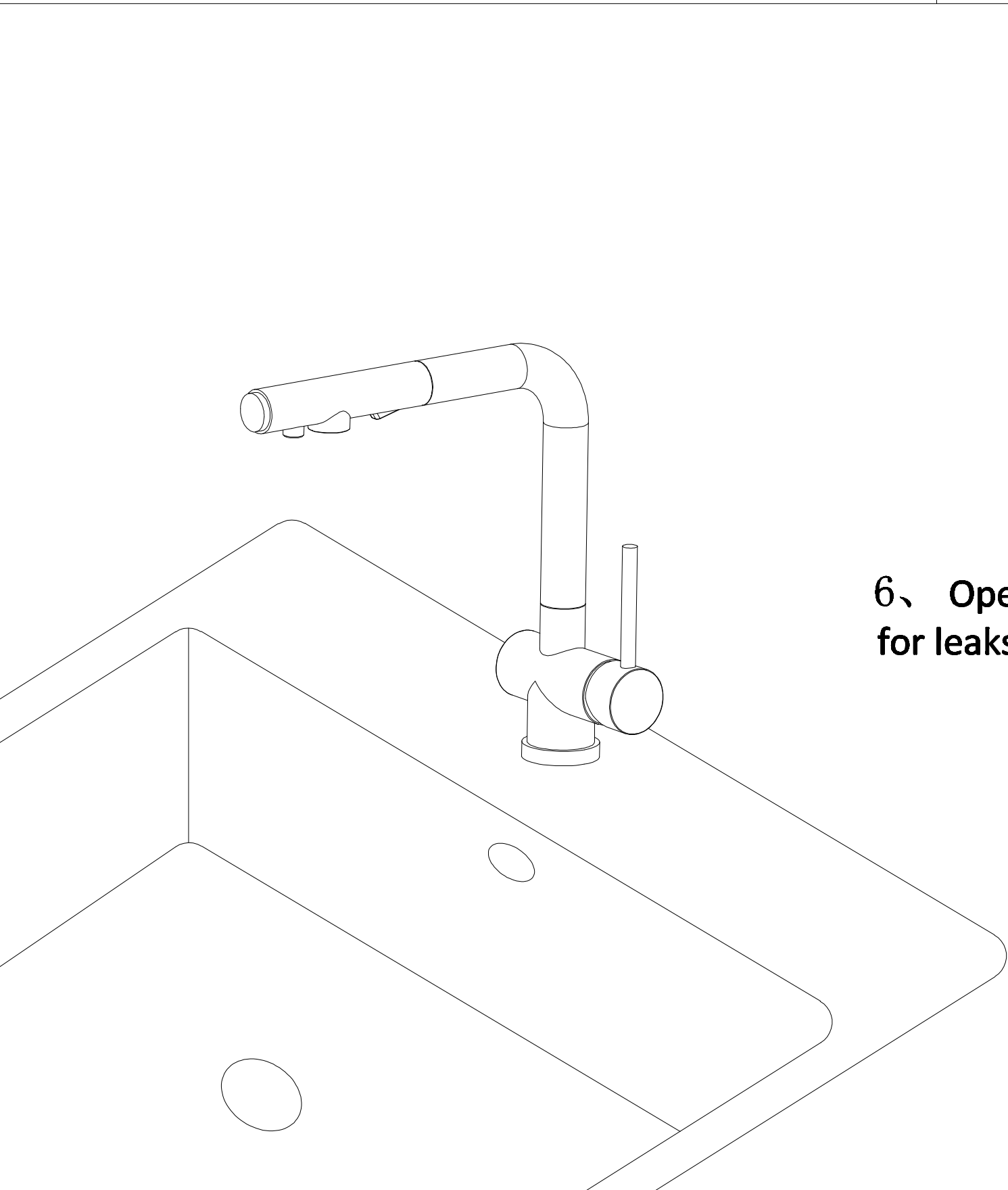

6、 Open the water. Check for leaks in the connections.

5. Usage instructions

- 1、 Turn on water supply, check all joints and connections for leaks.
- 2、 Handle down means open, the more angle, the more flow rate. The less angle, the less flow rate.
- 3、 Open the handle and turn left, the hot water supply will be increased. Turn right, the cold water supply will be increased.
- 4、 Spout can rotate for 360 degree.
- 5、 Press the button of shower bubble, the shower has bubble water. When press the button of shower head, it has shower water.Press the button on the right to discharge water from the water outlet, and press it again to turn off the water purification.

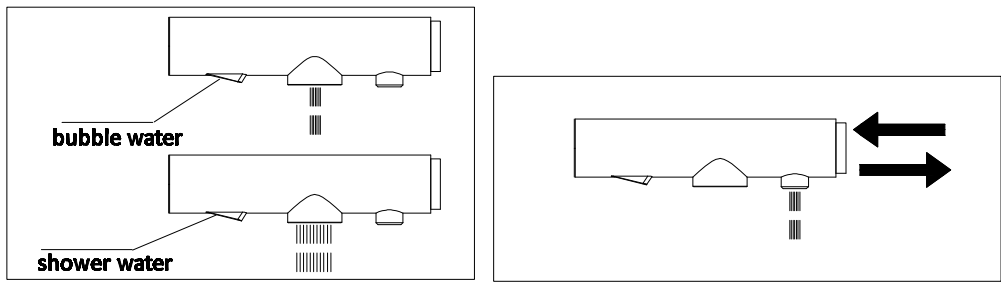
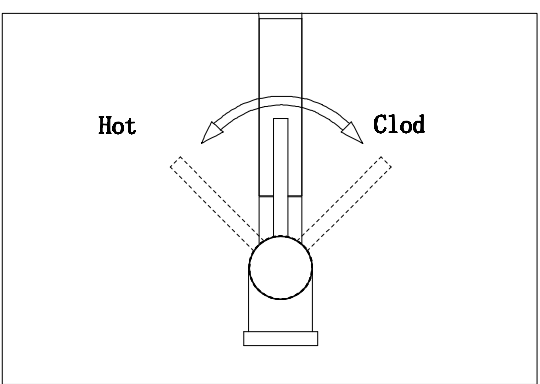
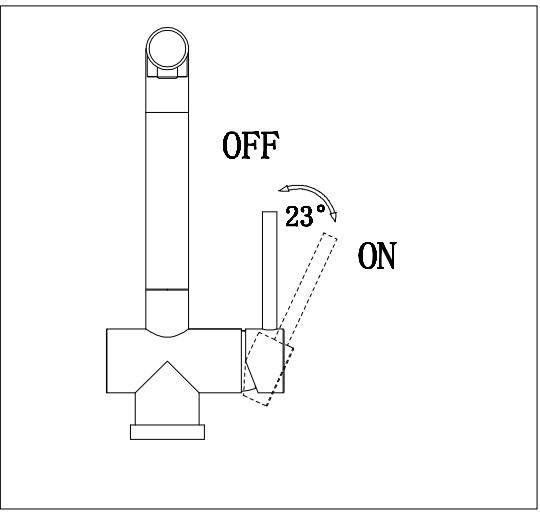

7. Consumer service guide

maintenance rules:

- The cartridge of our faucet is 5 years warranty, the rest accessories are only 1 year warranty. It is effected from the invoice date of purchasing the product.
- The following issues will be done with paid service, but do not in charge of any responsibility
- 1、 Due to the wrong installation and change the structure.
- 2、 The damage in the transportation
- 3、 Due to the normal degradation and do not use the original accessories.
- 4、 The damage of unprofessional maintainer caused
- 5、 The damage of weather caused
- 6、 The damage of low water pressure and quality and illegitimate use.

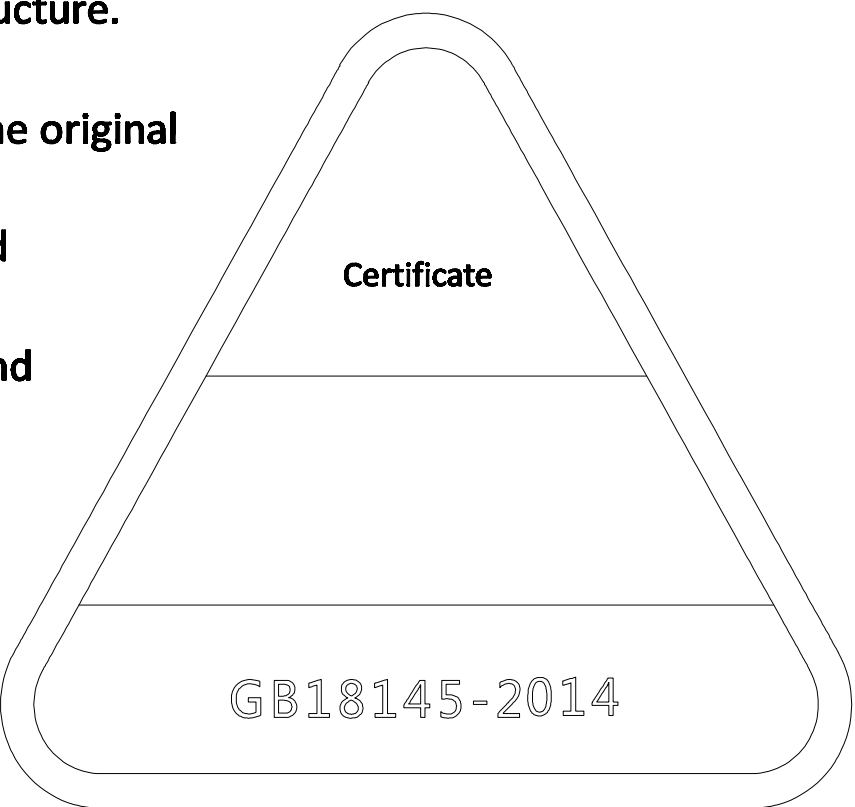

6. Care and Maintenance

In order to keep the mixer surface bright, please keep often or regularly to clean the mixer. Wash faucet with clean water, and wipe with soft cotton cloth. Avoid using cleaning powder, harsh cleaning chemicals, brushes, and cloth with coarse surface to prevent scratching and corrosion. Do not use acidic cleaning agents for washing the faucet as it may cause corrosion on the surface of faucet. Rinse off with water immediately if the faucet in contact with harmful acidic agents.

If must carry on the massive clearing, please obey the following procedure;

- 1、 Use clear water and the soft cloth, eliminate the superficial dirt and the filthy membrane as far as possible;
- 2、 Use the any following cleanser to remove the superficial dirt and the filthy membrane; Temperate liquid cleanser. The colorless glass cleaner, does not have the powdery cleanser which the drasive action and dissolve completely (according to instruction mix). Polish liquid which does not abrasive action.
- 3、 After cleanly, please remove the complete cleansing agent with the clear water, and wipes soft cotton fabric.

